

CRANACH®

INSTALLATION MANUAL

Freestanding Bathtub Faucet

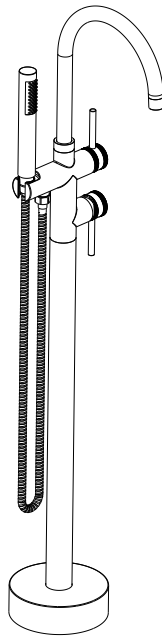

CO2.AN12

ENGLISH

SAFETY NOTES

- ⚠ Check the accessories list to verify that all parts are complete in this package.
- ⚠ Do not disassemble the main body by yourself.
- ⚠ Connect inlet pipes to supply valves.
- ⚠ Make sure inlet pipes and supply valves have no impurities and are cleaned, with no impurities in the pipeline.
- ⚠ After installation, check all joints for leakages.
- ⚠ Do not leave the rain shower system exposed to a severely corrosive environment.
- ⚠ Avoid using cleaning powder, harsh cleaning chemicals, brushes and coarse cloth to prevent scratching and friction.
- ⚠ Do not use acid cleaners to clean the faucet as they may cause surface corrosion of the faucet. If the faucet is exposed to harmful acid substances, please rinse it immediately with water.

INSTALLATION CONSIDERATIONS

CRANACH recommended that this unit be installed by a licensed professional plumber.

Before starting the installation, please read these instructions carefully and make sure you have all the required tools and materials on hand.

Keep this booklet and the receipt (or other proof of date and place of purchase) for this product in a safe place. The receipt is required should it be necessary to request warranty parts.

We're Here to Help!
Visit our Support Center for detailed product guides, warranty policies, and troubleshooting tips. Need instant assistance? Reach out via live chat or email us directly at support@cranachhome.com. For your convenience, we've provided quick access through the following QR codes:

Warranty Services
Scan the QR code below to quickly register your product warranty or access warranty-related information, ensuring peace of mind while using our products.



TOOLS REQUIRED

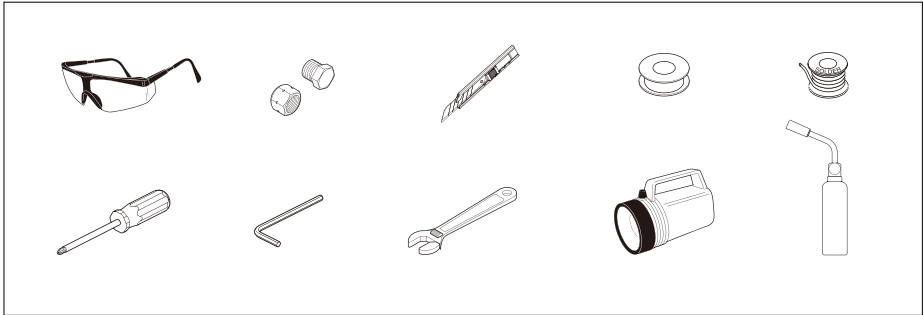

PARTS IN THE BOX

Read over these instructions thoroughly before beginning installation. Make sure that you have all tools and supplies needed to complete the installation.

C02.AN12

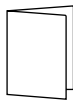

Installation Manual

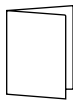

Warranty Card

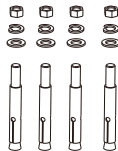

Concealed body parts



Gloves

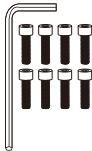

Mounting plate parts

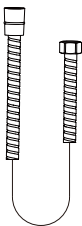
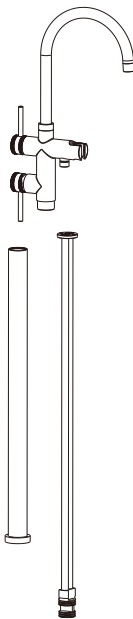

INSTALLATION

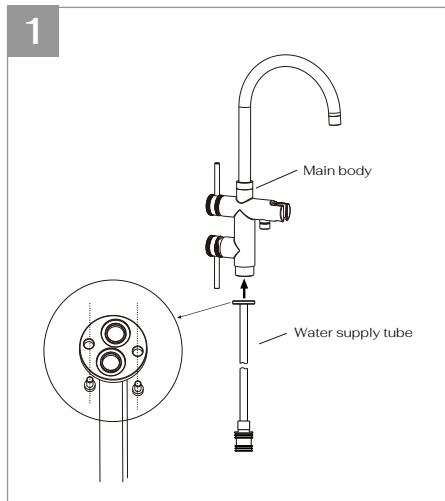

Connect the main body to the water supply tube using hex screws, following the direction indicated in the diagram. Make sure to tighten the screws securely; otherwise, leakage may occur.

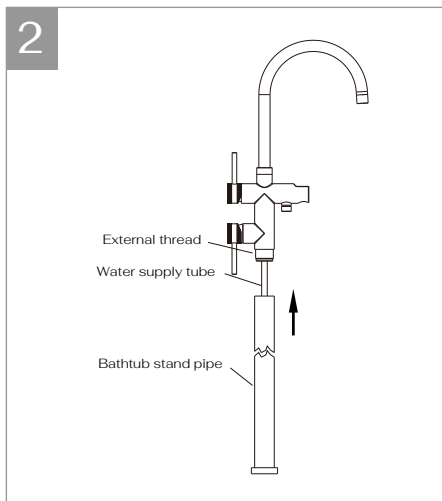

Insert the bathtub stand pipe into the water supply tube following the direction shown in the diagram until it reaches the external thread of the main body. Then, tighten it clockwise.

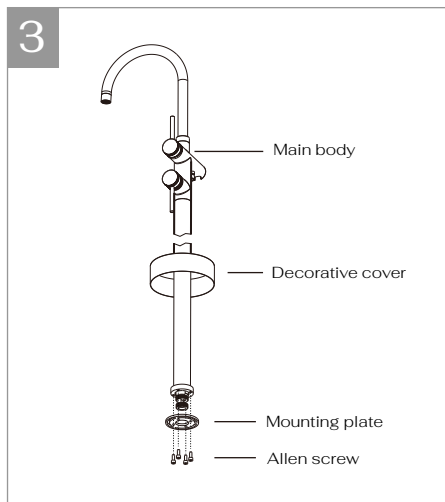

Align the mounting plate with the four screw holes at the bottom of the main body, then tighten the Allen screws as shown in the diagram.

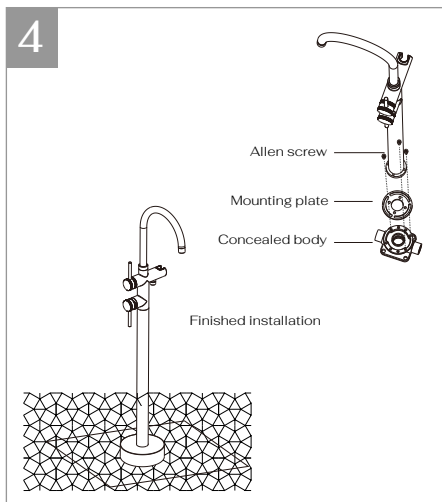

1. Rotate the main body to the appropriate position (adjust according to the actual water pipe installation location).

2. Use the remaining four hex socket screws to secure the fixing plate to the main body, integrating it with the concealed body into a single

5

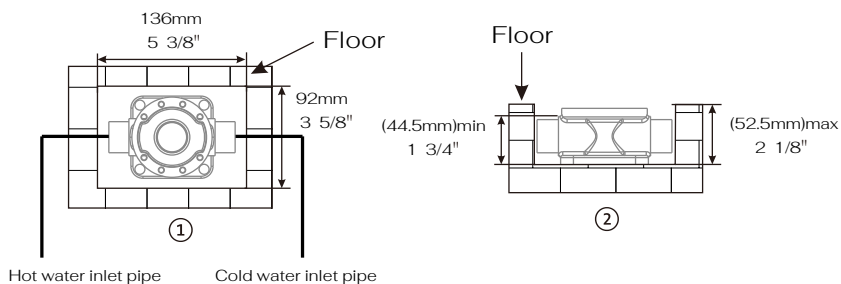

1.The opening dimensions on the room floor, including length and width, are shown in diagram ①. The installation depth of the embedded body is shown in diagram ②. 2.The dimensions must be between 44.5mm (1 3/4") and 52.5mm (2 1/8"). Accurately connect the hot and cold water inlet pipes according to the "H" (hot) and "C" (cold) markings on the concealed body.

6

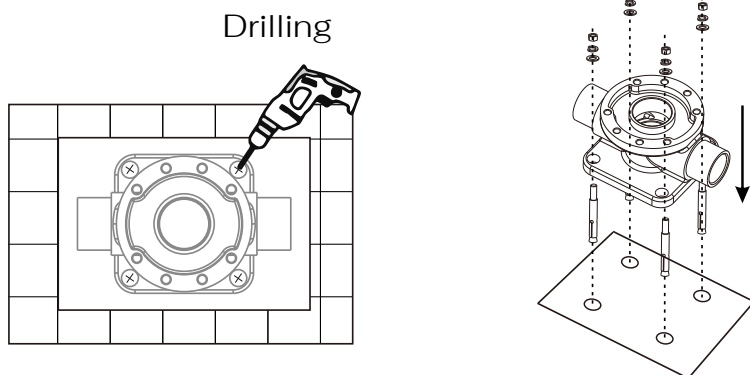

1.Place the concealed body at the center of the prepared hole, mark the positions of the four corresponding screw holes, and use a punch to drill the holes. 2.Insert the expansion screws into the holes (ensure an appropriate screw length is exposed for securing the main body and nut). 3.Then align the screw holes of the concealed body with the screws, and finally tighten the nut and washer.

WARRANTY

Parts and Finish:

All parts (excluding electronic parts and batteries) and finishes of CRANACH products purchased from authorized CRANACH sellers are warranted to the original consumer purchaser to be free from defects in material and workmanship for as long as the original consumer purchaser owns the home in which the faucet(s) are installed.

For commercial purchasers or multi-family residential properties (such as apartments and condominiums), the warranty period is 10 years from the date the product is received by the original purchaser or their authorized representative (e.g., installation contractor).

Electronic Parts:

Electronic parts (excluding batteries), if applicable, that are part of CRANACH products purchased from cranachhome.com or authorized CRANACH sellers are warranted to the original consumer purchaser to be free from defects in material and workmanship for 5 years from the date the product is received for residential use, 1 year for commercial purchasers. Batteries are not covered under this warranty.

What We Will Do:

If a defect is found during the applicable warranty period, CRANACH will provide replacement parts free of charge. This includes any part or finish that proves defective in material or workmanship under normal installation, use, and service. Before returning your faucet to CRANACH, please visit our website or contact our customer service team (via phone or email) for troubleshooting assistance.

Exclusions & Limitations:

This warranty does not cover damage caused by abuse, misuse, or improper care, lack of maintenance or improper installation, freezing water or excessive water pressure, abrasive cleaning products, or use in violation of applicable codes or regulations. Labor charges incurred during installation, repair, or replacement, damage incurred during installation or removal, or incidental or consequential damages, are excluded.

CARE AND CLEANING

Gently clean the product with clear water and wipe dry using a soft, lint-free cloth. Do not use soaps, acid, polish, abrasives or rough materials that may damage the surface.

CRANACH®

7933 Ley Rd Houston, TX, 77028

24hours Hotline:

+ (1) 888-263-8999

Email:

info@cranachhome.com

CR_INSTALLATION_V1.0_202501